

## QUICK GUIDE

### DIGITAL VOICE RECORDER JVJ DVR-952

**Safety notice:**

*Don't dismantle, assemble or alter the product arbitrarily*

*Don't use it in an aircraft or where the use of electronic instruments is prohibited.*

*Don't drop it in water or drop water on it.*

*Don't leave in Sunlight directly or near heaters for any length of time*

*Recording other than for your own personal use is illegal*

#### Feature:

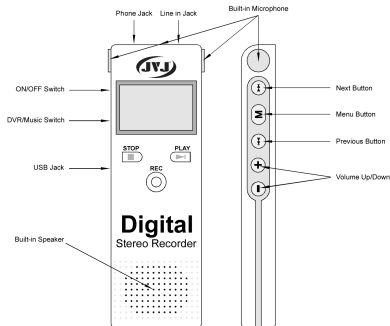

- Telephone Recording
- VOR (Voice Operated Recording)
- Built in Speaker
- Multi Recording Mode (HQ/SP/LP)
- Maximum 266 Hours Recording (1GB)
- Playback & Built-in Speaker support
- Power Supply by USB port support
- Support MP3 & WMA File format
- FM / Voice Timer Recording Setting
- Voice Timer Recording
- Data Storage Function

## RECORDING (DVR MODE)

1. Switch the ON/OFF Switch to ON position.
2. Switch the DVR/MUSIC Switch to DVR position.
3. If the appliance doesn't start press and hold PLAY button for a few moments.
4. Set the desired function and quality before you start recording.
5. Make a test recording to make sure that all setting are correct.

### 1. Microphone Recording:

#### ***Recording with built-in microphones***

This DVR comes with 3 built-in microphones so it is possible to record without any external microphone

1. Point the DVR's built-in microphones toward the sound source.
2. Press REC button to start/pause recording.
3. Press STOP button to stop recording

#### ***Recording with exclusive microphone***

To record with an external microphone, connect the microphone with LINE IN jack and follow the same procedure as for the built-in microphone

*\* While recording, you can listen what are recording by enabling the LISTEN IN SE mode: Press M button then choose Listen Enable.*

*\*\* To playback recorded file press PLAY button*

## 2. Telephone Recording:

1. Connect external Input Device/MIC jack and Telephone using connection cable for External Device and adaptor for Telephone record as follow:

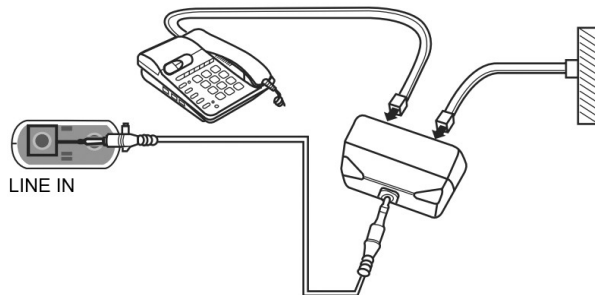

2. Press REC while phone call to begin record.
3. Press REC to stop record.

*\* To make device records automatically turn on VOR mode.*

### 3. External Devices Recording:

1. Connect external Input Device/MIC jack and External Device using connection cable for External Device as follow:

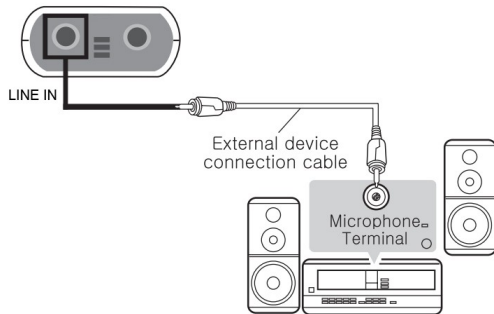

2. Press REC to begin record.
3. Press REC once more to stop record.

*\* To make device records automatically turn on VOR mode.*

#### **4. FM Radio Recording:**

1. If you are not in FM RADIO mode change into FM Radio mode by switch DVR/MUSIC switch to MUSIC position, press M button to call Menu then select FM and press M button to get into FM RADIO mode.
2. In FM RADIO mode, press M button to call FM radio Sub Menu then choose RECORD to begin record broadcasting program.

*\* There could be a recording noise when radio receive sensity is not good enough*

#### **5. Recoding Setting:**

##### ***VOR – Voice Operated Recording***

This function stops recording when there is no sound and starts recording automatically when DVR detects sound

1. When DVR is in RECORDING mode and stop press M button for Recording Sub Menu.
2. In VOR Control option select ON or OFF.

##### ***Recording Type Selection***

There are 4 recording modes: STEREO – STANDARD – LONG – PHONE. STEREO, STANDARD and LONG mode are for Voice Recording.

1. When DVR is in RECORDING mode and stop press M button for Recording Sub Menu.
2. In Record Type option select desired mode, press M button to accept

*\* For more details about Recording Type see Table 1*

### ***Recording Time Selection***

When DVR is in RECORDING mode and stop press M button for Recording Sub Menu, select Record Time. The options are:

1. *Real Time*: device's clock setting (useful if you plan to schedule recording). To adjust clock press either (+) or (-) button to select then press NEXT or PREVIOUS buttons to change. Press M button briefly to accept.
2. *Time Record*: preset time to begin recording automatically. To preset Time record press either (+) or (-) button to select then press NEXT or PREVIOUS buttons to change. Press M button briefly to accept.
3. *Timer Length*: limit interval recording time

## **PLAYING (MUSIC MODE)**

1. Switch the ON/OFF Switch to ON position.
2. Switch the DVR/MUSIC Switch to MUSIC position.
3. If the appliance doesn't start press and hold PLAY button for a few moments.
4. Press NEXT/PREVIOUS buttons to select MUS mode, press M button to start playing

### **1. Normal Playing:**

1. Press NEXT/PREVIOUS buttons to choose desired file.
2. Press PLAY button to play/pause.
3. Adjust the volume by press VOLUME UP/DOWN buttons.

## **2. Search:**

1. Press and hold NEXT/PREVIOUS buttons during playback to scan forward/backward in the current files at a fast speed. When you release these buttons playback will resume to normal speed.
2. Press NEXT/PREVIOUS buttons briefly to skip to next/previous files.

## **3. Repeat Playing:**

### ***Repeating a Section***

1. During playback press REC button to mark the beginning point of the section.
2. Press REC button once more at the ending point of the section. The selected section will repeat continuously until you press REC button again.
3. To return to normal playback press REC button.

### ***Repeating a File***

1. During playback press M button to call Playing Sub Menu.
2. Press NEXT/PREVIOUS buttons to choose Repeat option, press M button to get into..
3. Press NEXT/PREVIOUS buttons to change to Repeat One option, press M button to accept.

### ***Repeating all files in a Folder***

1. During playback press M button to call Playing Sub Menu.
2. Press NEXT/PREVIOUS buttons to choose Repeat option, press M button to get into..
3. Press NEXT/PREVIOUS buttons to change to Folder option, press M button to accept. All files in current folder will be played repeatedly

### ***Repeating all Folders***

1. During playback press M button to call Playing Sub Menu.
2. Press NEXT/PREVIOUS buttons to choose Repeat option, press M button to get into.
3. Press NEXT/PREVIOUS buttons to change to Rep Folder option, press M button to accept. All files in all folders will be played repeatedly

### **4. Equalizer Setting:**

1. Press M button to call Playing Sub Menu.
2. Press NEXT/PREVIOUS buttons to choose Equalizer option, press M button to get into..
3. Press NEXT/PREVIOUS buttons to choose desired Equalizer mode (Natural - Rock - Pop - Clas - Soft - Jazz - DBB), press M button to accept.

*\* Attention: Listening to music at high volume can permanently damage your hearing.*

## **FM RADIO (RADIO MODE)**

1. Switch the ON/OFF Switch to ON position.
2. Switch the DVR/MUSIC Switch to MUSIC position.
3. If the appliance doesn't start press and hold PLAY button for a few moments.
4. Press NEXT/PREVIOUS buttons to select FM mode, press M button to start.
5. Connect the earphone. FM reception is not possible without earphone connection because it functions as the antenna

### **1. Change Frequency:**

1. Press NEXT/PREVIOUS buttons briefly.
2. The frequency will change by 100Khz.

### **2. Frequency scanning:**

1. Press NEXT/PREVIOUS and hold buttons for a moment
2. The DVR will scan FM frequency band automatically and stopping at the first station it finds.

### **3. Manual programing:**

1. Search for desire station as mention above.
2. Press M button to call FM Sub Menu.
3. Press NEXT/PREVIOUS buttons to select Save option, press M button to accept.

### **3. Automatic programing:**

1. Press M button to call FM Sub Menu.
2. Press NEXT/PREVIOUS buttons to select Auto Search option, press M button to carry out.
3. The DVR will scan every FM frequency band available and save each station automatically

## **CAMPUS BAND (RADIO MODE)**

This mode is the same as FM mode with the frequency from 76 to 86 MHz

## **OTHER SETTING (SETTING MODE)**

1. Switch the ON/OFF Switch to ON position.
2. Switch the DVR/MUSIC Switch to MUSIC position.
3. If the appliance doesn't start press and hold PLAY button for a few moments.
4. Press NEXT/PREVIOUS buttons to select SETTING mode, press M button to start.

### **1. Backlight:**

1. Press NEXT/PREVIOUS buttons to select Backlight option, press M button to select.
2. Press NEXT/PREVIOUS buttons to increase/decrease backlight, press M button to accept.

### **2. Language:**

1. Press NEXT/PREVIOUS buttons to select Language option, press M button to select.
2. Press NEXT/PREVIOUS buttons to change to desired language, press M button to accept.

### **3. Power off:**

1. Press NEXT/PREVIOUS buttons to select Power off option, press M button to select.
2. Set Off time or Sleep time by pressing NEXT/PREVIOUS buttons.

### **4. Contrast:**

1. Press NEXT/PREVIOUS buttons to select Contrast option, press M button to select.
2. Press NEXT/PREVIOUS buttons to increase/decrease contrast, press M button to accept.

## 5. Memory info / Firmware version:

1. Press NEXT/PREVIOUS buttons to select Memory Info / Firmware option, press M button to select.
2. The DVR will shows the information as need.

Table 1.

Recording Mode	Maximum Recording time (h)		Bit rate
	Fully charged Battery	Every 1GB capacity	
Stereo REC	9	17	128 kbps
Standard REC	20	66	32 kbps
Long REC	18	266	8 kbps